

Pro5000sL

Jack of All Trades

The Pro5000sL is a large room necessity!
3 optional lenses ranging from a 1.8:1 to a 4.1:1 throw ratio, this projector works for you. With a generous input panel and easy install features, you will wonder where it has been all your life!



*Pro5000SL shown with standard lens

- 3 lens options from 1.8 to 4.1:1 throw ratios
- Email monitoring
- Web access via network management software
- Quick install features
 - Auto ceiling detection
 - Auto keystone correction
 - Auto brightness control



Pro5000sL

Specifications

*No Lens Included



BRIGHTNESS

5000 Lumens (Standard)
4000 Lumens (Economy)

RESOLUTION

1024x768 XGA (Native)
1280x1024 SXGA (Supported)

DISPLAY TYPE

0.79" LCD MLA x 3 

CONTRAST RATIO

500 :1

ASPECT RATIO

4:3 Native
16:9 Compatible

THROW RATIO

1.8-2.3 Pro5000SL-911
2.3-2.9 Pro5000SL-912
3.1-4.1 Pro5000SL-913

PROJECTION LENS

Manual Zoom & Focus

ZOOM RATIO

1.27 Standard
1.25 Medium
1.26 Long

DIAGONAL IMAGE SIZE

40" - 300"
101.6cm - 762cm

THROW DISTANCE

4' - 30'
1.2m - 9.1m

KEystone

+/- 30° Vertical

LAMP

330 watt NSH

LAMP LIFE

2000 (Standard)
3000 (Economy)

INPUTS

DVI-I w/3.5 mm Audio
VGA w/3.5 mm Audio
S-Video
Component
Composite Video
Audio (3.5 mm)
RCA R/L Audio

OUTPUTS

VGA w/ 3.5mm Audio

PROJECTOR CONTROLS

USB
RS232 (9-pin)
RJ45 (LAN Control)

COMPATIBILITY

VGA, SVGA, XGA, SXGA, MAC

EDTV / SDTV / HDTV

480i/p, 525i/p, 576i/p, 625i/p,
720p, 1080i

FCC CERTIFICATION

FCC-B, UL, TUV-CB, c-UL, CB, CE,
CCC

VIDEO COMPATIBILITY

NTSC, NTSC 4.43, PAL B/G/H/I/M/N 60,
SECAM

AUDIO

1 x 8w Mono Speaker

DECIBEL RATING

40 dB (Standard)
35 dB (Economy)

H-SCAN FREQUENCY

15-107 kHz

V-REFRESH RATE

43-120 kHz

POWER SUPPLY

AC 100-240 Volts (50/60 Hz)

POWER CONSUMPTION

430 Watts (Typical)

DIMENSIONS (WxDxH)

18.9" x 14.2" x 5.7"
48cm x 36.1cm x 14.5cm

WEIGHT

15 lbs (with no lens)
6.8 kg (with no lens)

WARRANTY

3 year parts & labor / 90 day lamp

Pro5000sL Product Highlights:

- 3 optional lenses from 1.8 to 4.1 throw ratio.
- Advanced LAN control including email monitoring and online web access and scheduling.
- Easy installation function, auto key stone, and auto ceiling mount detection.
- Long lasting Hepa filtration system with upgradable smoke control option.
- Auto brightness detection to extend lamp life and out put only what is needed.

Choose from 3 lens options:



Standard Throw Lens
1.8-2.3 throw ratio
1.27 zoom



Medium Throw Lens
2.3-2.9 throw ratio
1.25 zoom



Long Throw Lens
3.1-4.1 throw ratio
1.26 zoom

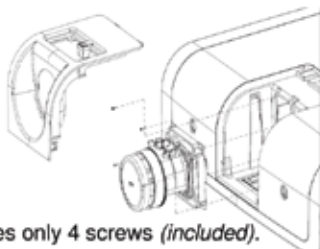

Easy optional lens installation requires only 4 screws (included).

- (5) Speaker
- (11) Filter cover
The air filter is inside.
- (14) AC inlet
- (15) S-VIDEO port
- (16) AUDIO L/R port
- (17) VIDEO port
- (18) COMPUTER IN1 port
- (19) COMPUTER IN2 / DVI port
- (20) USB port
- (21) AUDIO 1 IN port
- (22) AUDIO 2 IN port
- (23) AUDIO OUT port
- (24) MONITOR OUT port
- (25) YPbPr port
- &(26) L-AUDIO IN-R port
- (28) RS-232C port
- (29) LAN port

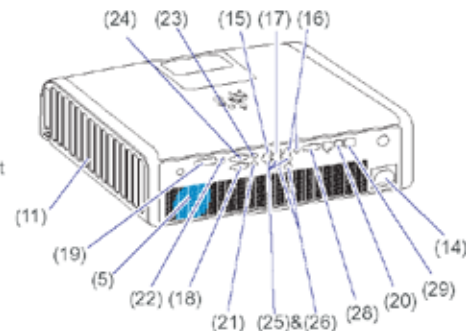

www.boxlight.com
360.464.2119